

BYLAW NO 178

A BYLAW TO REGULATE TRAFFIC IN THE TOWN OF BALGONIE

THE COUNCIL OF THE TOWN OF BALGONIE IN THE PROVINCE OF SASKATCHEWAN ENACTS AS FOLLOWS:

PART I: INTERPRETATION

1. TITLE:

This Bylaw shall be known and may be cited as "The Balgonie Traffic Bylaw".

2. DEFINITIONS:

In this Bylaw, unless the context otherwise requires, the expressions:

"Administrator" means the Administrator for the Town of Balgonie and anyone authorized to act on behalf of the Administrator.

"Alley" means that kind of public highway intended primarily to give vehicles access to the rear or side of real property.

"Boulevard" means the strip of land between the curb and the sidewalk and between the sidewalk and the property line or, where there is no sidewalk, the strip of land between the curb and the property line.

"Block" means the portion of a street which lies between two other streets neither of which is an alley and which both intersect the first named street.

"Council" means the Council of the Town of Balgonie.

"Cul-de-sac" means a local street open at one end only and with special provisions for turning around.

"Curb" means the actual curb to a street and if there be no curb in existence, shall mean the dividing line between that part of a public highway intended for the use of vehicles and that part of a public highway intended for use by pedestrians.

"Curb Crossing" means that portion of a sidewalk or curb permanently improved or designed for the passage of vehicular traffic across the sidewalk or curb.

"Dangerous Goods" shall have the same meaning as defined under The Transportation of Dangerous Goods Act (Canada)

"Emergency Vehicle" means a licence ambulance, a vehicle in the service of the R.C.M. Police Service or the Balgonie Volunteer Fire Department or the E.M.O. Response Vehicles.

"Heavy Vehicle" means:

(1) a motor vehicle with a gross weight registration exceeding nine thousand kilograms (9,000 kg.)

(2) a vehicle, including any combination of motor vehicle, trailer and load, with a total weight exceeding nine thousand kilograms (9,000 kg.).

"Intersection" means that portion of the roadway where two or more public highways intersect.

"Motor Vehicle" means a vehicle propelled or driven by any means other than by muscular power.

"Operator" means any person who drives, operates or is in charge of a vehicle.

"Parade" means any group of pedestrians marching or walking along a public highway and numbering fifty (50) or more or any group of vehicles numbering ten (10) or more and preceding on a public highway under a common leadership except funeral processions.

"Parking" means the standing of a vehicle, whether occupied or not, on a public highway, otherwise than temporarily for the purpose of and while actually engaged in loading or unloading or in obedience to traffic regulations, signs or signals.

"Parking Stall" means a portion of a public highway or an area indicated by signs, markings, meters or physical barriers as a parking space for a single vehicle.

"Pedestrian" means any person afoot or confined to a wheelchair.

"Pedestrian Corridor" means a crosswalk that has been designated as a Pedestrian Corridor that is indicated for pedestrian crossing by overhead pedestrian crossing signs equipped with flashing signals.

"Pedestrian Crosswalk" means:

(i) that portion of a public highway designated by signs or markings for the use of pedestrians to cross a public highway;

(ii) where there are no signs or markings, that portion of a public highway within the prolongation of the lateral boundary lines of the adjacent or intersecting sidewalks at the end of a block; or

(iii) where there are no signs or markings or sidewalks, that portion of the roadway measured five meters back from the street intersection and parallel across the roadway.

"Police Officer" means any member of the Royal Canadian Mounted Police.

"Public Highway" means a street, alley or other road designed and intended for or used by the general public for the passage of vehicles, but does not include any private or publicly owned area primarily intended to be used for the parking of vehicles and the necessary passageways on that area.

"Road Construction Equipment" means self-propelled or towed equipment used directly in road construction, but does not include a truck, trailer, semi-trailer unit or road construction equipment transported on a truck, trailer or semi-trailer unit.

"Sidewalk" means the actual sidewalk where constructed on or adjacent to a part of a public highway or that portion of a public highway intended primarily for use by pedestrians or any structure in a park or other public place designed and intended for use by pedestrians.

"Special Constable" means any person, appointed by Bylaw, as Special Constable for the Town of Balgonie.

"Stop" means:

(i) when required, a complete cessation from movement; and
(ii) when prohibited, any stopping, even momentarily of a vehicle, whether occupied or not, except when necessary to avoid conflict with other traffic or in compliance with the directions of a peace officer or a traffic control signal.

"Street" means that portion of a public highway lying between curbs where constructed and intended primarily for use by vehicles, or where no curb exists, that portion of a public highway intended for use by vehicles.

"Town" means Town of Balgonie.

"Traffic" means the movement of pedestrians, vehicles or livestock upon any public highway in the Town of Balgonie.

"Traffic Lane" means a longitudinal division of a highway of sufficient width to accommodate the passage of a single line of vehicles.

"Vehicle" means a device in, upon or by which a person or thing is or may be transported or drawn upon a highway and includes special mobile machines and agricultural implements, and for the purpose of parking and stopping restrictions, included any portion of a vehicle.

PART II: TRAFFIC SIGNS

3. ERECTION OF SIGNS:

(1) The Administrator is hereby authorized to erect and maintain signs for the purpose of the control, warning, guidance, information and direction of traffic in conformity with the provisions of this Bylaw or any traffic warrants approved by Council.

(2) The Administrator shall keep a record of the location of all traffic control signs and devices and zones where parking or stopping is restricted by sign and the record shall be open to inspection at the office of the Administrator of the Town of Balgonie during normal business hours.

4. PROTECTION OF SIGNS

No person shall damage, deface, remove, obscure or interfere with any sign, marker or barricade placed or maintained by the Town for the purpose of traffic control.

5. PROHIBITION

No person shall erect or maintain or cause the erection or maintenance of any sign or marker on any public highway or boulevard unless authorized by Council.

6. DIRECTIONAL ARROWS

Where a sign indicated parking or stopping restrictions by directional arrow, that restriction shall continue in the direction of the arrow to the next street intersection unless interrupted by a similar sign with a facing arrow or by permitted parking signs.

PART III: TRAFFIC ROUTES

7. HEAVY VEHICLE ROUTE

(1) No person shall operate a heavy vehicle on any street except:

(a) upon the streets set out in Schedule "A" to this Bylaw, which streets are hereby established as heavy vehicle routes;

(b) while such heavy vehicle is making collection or delivery, provided that the operator proceeds by the most direct route to or from the point of collection or delivery, as the case may be, to or from the nearest heavy vehicle route;

(c) while such heavy vehicle is proceeding to or from the residence or business premises of the owner or operator of the heavy vehicle provided that the operator proceeds by the most direct route to or from the residence or business premises, as the case may be, to or from the nearest heavy vehicle route;

(d) while such heavy vehicle is proceeding to or from a garage for the purpose of repairs, servicing or refueling, provided that the operator proceeds by the most direct route to or from the garage, as the case may be, to or from the nearest heavy vehicle route;

(e) while such heavy vehicle is being operated in the service of the Town.

(2) No operator of a vehicle shall fail to comply with a request of a police officer or special constable to immediately proceed to a Weigh Scale and there allow the vehicle to be weighed, for the purpose of determining whether the vehicle is a heavy vehicle.

PART IV: RESTRICTED USE OF HIGHWAYS

8. TEMPORARY ROAD CLOSURE

(1) Notwithstanding any other provisions in the Bylaw the Administrator shall have authority to temporarily close to vehicular traffic or restrict parking or stopping on any public highway for the purpose of:

(a) enabling work to be carried out by or on behalf of the Town, including road maintenance, street cleaning, snow removal and sewer or water line construction, repair or improvements;

(b) facilitating the moving of any building, structure, machine or other object;

(c) facilitating the construction, repair or demolition of a building, structure or other object;

(d) facilitating public gatherings.

(2) Notwithstanding any other provision in the Bylaw a Police Officer and/or a Special Constable shall have authority to temporarily close to vehicular traffic or restrict parking or stopping on any public highway for the purpose of a parade or assembly of persons.

(3) Where a public highway is temporarily closed, the Administrator shall cause the highway to be marked with a sign indicating the closure and the hazards, if any, that would be encountered in its use.

(4) No person shall operate a vehicle upon any public highway temporarily closed to vehicular traffic by authority of this Bylaw or any other Bylaw of Council.

(5) No person shall park or stop a vehicle upon any public highway where parking or stopping is temporarily restricted by authority of this Bylaw or any other Bylaw of Council.

9.

PARADES

(1) The Administrator shall have the authority to issue a parade permit, in a form as set out in Schedule "B" to this Bylaw, to hold a parade or assembly of persons upon a public highway upon receipt of an application in writing for a parade permit not less than forty-eight (48) hours before the time proposed for commencement of the parade and giving full particulars for the parade.

(2) No person shall hold, take part in or be a member of a parade or assembly on a public highway unless a parade permit has been obtained.

(3) No person shall cross through or in any way obstruct or interfere with a parade or assembly for which a parade permit has been obtained.

10.

BUILDING MOVE

(1) The Administrator shall have authority to issue a moving permit, in a form as set out in Schedule "C" to this Bylaw, for the moving of a building, structure, machine or other object over a public highway upon:

(a) receipt of an application in writing for a moving permit not less than seventy-two (72) hours before the commencement of the move and giving full particulars of the move;

(b) the issuance of a building permit to the applicant by the Urban Development Department of the Town authorizing the move;

(c) the issuance of any building move permit required by Saskatchewan Power and Saskatchewan Telecommunications;

(d) receipt of an agreement or deposit by the applicant to bear all costs for signing, barricading, pole removal and damage to property.

(2) No person shall move a building or other structure the dimensions of which, including the vehicle and trailer, exceed;

(a) 3.7 meters in width;

(b) 24.4 meters in length; or

(c) 4.2 meters in height;

over a public highway without first obtaining a moving permit and then only in compliance with the terms of that permit.

11. ENCROACHMENT PERMIT

(1) The Administrator shall have authority to issue an encroachment permit, in a form as set out by Schedule "D" to this Bylaw, for encroachment upon a public highway, sidewalk or boulevard for up to three weeks:

(a) during the construction, repair or demolition of a building, structure or other object;

upon:

(b) receipt of an application in writing for an encroachment permit not less than seventy-two (72) hours before the commencement of the construction, repair or demolition and giving full particulars of the proposed encroachment;

(c) the issuance of any required building or demolition permits to the applicant by the Urban Development Department of the Town;

(d) the issuance of any permits required by Saskatchewan Power and Saskatchewan Telecommunications;

(e) execution of an agreement by the applicant to bear all costs of signing, barricading and damage to property;

(f) receipt of a fee as established in Schedule "D"; and

(g) satisfying himself that the encroachment will not unduly interfere with traffic or endanger public safety.

(2) No person shall cause or allow any thing to encroach upon a public highway, sidewalk or boulevard without first obtaining:

(a) an encroachment permit and then only in compliance with the terms of the encroachment permit; or

(b) approval of Council.

(3) The Administrator may suspend or revoke an encroachment permit issued by himself or suspend an encroachment approved by Council where the applicant fails to abide by an condition of the permit or approval or where the encroachment unduly interferes with traffic or endangers public safety.

12. REPAIR OF VEHICLE

(1) No person shall wash, repair, dismantle or otherwise work on a vehicle upon a public highway, except in case of emergency and then only in the curb lane of the street.

(2) No person shall leave any vehicle for more than three (3) hours on any public highway or boulevard when that vehicle has been placed on a jack or blocks.

13. STOP SIGNS

The Council may erect and maintain, as funding permits, stop signs at street intersections which satisfy the requirements of traffic warrants as stated in Schedule "E" to this bylaw.

14. YIELD SIGNS

The Council may erect and maintain, as funding permits, yield signs at street intersections which satisfy the requirements of traffic warrants as stated in Schedule "F" to this Bylaw.

15. PEDESTRIAN CORRIDORS

(1) The Council may establish and maintain pedestrian corridors, as funding permits, at locations which satisfy the requirements of traffic warrants as stated in Schedule "G" to this Bylaw.

(2) The Council may establish no passing zones on the street at a pedestrian corridor by posting signs as shown in Schedule "G" on one or both sides of the pedestrian corridor. Where no signs are posted, a No Passing Zone shall exist within thirty meters of either side of the pedestrian corridor.

(3) No person operating a vehicle shall pass or overtake another vehicle travelling in a No Passing Zone at a pedestrian corridor.

16. CORD ACROSS SIDEWALK

(1) No person shall place or leave any cord or cable across or upon any public highway or sidewalk.

(2) No person shall allow any cord or cable left across or upon any public highway or sidewalk to be attached to their vehicle while that vehicle is parked on a street.

17. SIGHT LINE CONTROLS

(1) Schedule "H" to this Bylaw, being entitled "Intersection Sight Line Control", is hereby adopted and forms part of this Bylaw.

(2) No person, being owner or occupant of a property, shall cause or allow the planting, erection, maintenance or keeping of any plant, tree, fence or other structure on that portion of the property or adjacent boulevard shown in Schedule "H" except as permitted by that Schedule.

(3) The Council may remove any plant, tree, fence or other structure not permitted by Schedule "H".

PART V: MOVING VIOLATIONS

18. SPEED LIMIT

No person shall operate a vehicle on any public highway in excess of the speed limit as set out in Schedule "I" to this Bylaw.

19. OBSTRUCTING TRAFFIC

(1) No person shall obstruct, interfere with or interrupt the free passage of traffic on any public highway.

(2) No person shall obstruct, interfere with or interrupt the free passage of traffic on any sidewalk.

20. ENTERING INTERSECTION

(1) No person operating a vehicle shall enter a street intersection unless:

(a) there is sufficient space on the other side of the intersection to accommodate the vehicle without obstructing the passage of cross traffic.

(2) No person operating a vehicle in the curb lane of a street shall overtake a vehicle travelling in the same direction in the adjacent traffic lanes:

(a) during any time when parking is permitted in the curb lane; and

(b) where there are more than two traffic lanes on that side of the street, including the curb lane and any turning lane;

except:

(c) for the purpose of making a right turn onto or off of the street block in which the vehicle entered the curb lane;

(d) for the purpose of parking on the street block;

(e) to cross a street intersection where the projection of the curb lane continue across the intersection into a traffic lane adjacent to a curb lane.

(3) Subsection (2) shall not apply:

(i) to bicycles or emergency vehicles operated by the Town;

(ii) where traffic is obstructed in the adjacent traffic lane by the breakdown of a vehicle or a traffic accident.

21. LEAVING STATIONARY POSITION

No person operating a vehicle on a public highway shall, when moving from a stationary position in the curb lane or at the side of the highway into the flow of traffic, fail to yield the right of way to traffic in the driving lanes.

22. SPLASHING

No person operating a vehicle on a public highway shall:

(a) splash any pedestrian; or

(b) project dirt or water at or onto any pedestrian or other vehicle by spinning tires or accelerating quickly.

23. U-TURNS

(1) No person operating a vehicle shall turn the vehicle so as to proceed in the opposite direction at:

(a) a street intersection controlled by traffic signals;

(b) a street intersection where a sign as shown in Schedule "J" to this Bylaw is displayed;

(c) a break in the center median except where a sign as show in Schedule "J" to this Bylaw is displayed.

(2) No person operating a vehicle, having turned or turning the vehicle so as to proceed in the opposite direction, shall so proceed until it is safe to do so.

24. CROSSING CURB

No person operating a vehicle shall drive the vehicle across a curb or sidewalk except at t curb crossing, unless a Temporary Curb Crossing Permit in a form as shown in Schedule "N" to this Bylaw has been obtained from the Administrator.

25. CROSSING FIRE HOSE

No person operating a vehicle shall drive the vehicle across or stand a vehicle upon any fire equipment, including water hose, which is in use or intended to be used by members of the Balgonie Volunteer Fire Department.

PART VI: PARKING & STOPPING**26. PARKING**

Where parking is permitted, vehicles shall park parallel to or alongside the curb unless angle parking is indicated by signs or markings.

27. PARKING AT CURB

No person shall park a vehicle upon a street except at the right-hand curb on a two way street and in the direction of traffic on that side of the street, provided such parking is not otherwise prohibited by this Bylaw.

28. PARALLEL PARKING

(1) No person shall park a vehicle on a street where parallel parking is provided:

(a) with the front or rear wheel nearest the curb more than 0.3 meters from that curb;

(b) within 0.6 meters of any vehicle previously parked in front of or behind the vehicle.

(2) Notwithstanding subsection (1), where the vehicle is a solo motorcycle, the operator shall park the vehicle at an angle of forty-five (45) degrees to the curb with the rear wheel within 0.3 meters of the curb.

29. ANGLE PARKING

No person shall park a vehicle on any street where angle parking is provided except:

(a) in accordance with signs or markings designating a parking stall;

(b) with the front end of the vehicle within 0.3 meters of the curb;

(c) where the vehicle measures less than six meters in overall length.

30. NO PARKING

No person shall park a vehicle:

(a) on any street where parking is prohibited by display of a sign as shown in Schedule "K" to this Bylaw;

(b) on any street where parking is limited by display of a sign as shown in Schedule "K" to this Bylaw for a longer period than allowed by this sign;

(c) on any alley in the Town of Balgonie;

- (d) within ten meters (10m) of a street intersection, as measured in Schedule "L" to this Bylaw;
- (e) within three meters (3m) of a alley intersection, as measured in Schedule "L" to this Bylaw;
- (f) within two meters (2m) of any curb crossing, as measured in Schedule "L" to this Bylaw;
- (g) within two meters (2m) of a fire hydrant, measured parallel to the curb, as measured in Schedule "L" to this Bylaw;
- (h) within five meters (5m) of any railway track, as measured in Schedule "L" to this Bylaw;
- (i) on any street on the side adjacent to a school or school ground during any school day from 8:00 a.m. to 6:00 p.m.;
- (j) on any sidewalk;
- (k) on any portion of a boulevard or center median;
- (l) in a driving lane of any street;
- (m) on any public highway on which parking has been temporarily restricted, pursuant to Part IV of this Bylaw;
- (n) on any public highway which has been temporarily closed to vehicular traffic, pursuant to Part IV of this Bylaw;
- (o) in any place not accessible to a public highway by a curb crossing;
- (p) on any public highway for more than twenty-four (24) hours except for Saturdays and holidays.

31. PRIVATE PROPERTY

No person shall park a vehicle on private property except with the express consent of the owner, occupant or permittee of that property.

32. PUBLIC PROPERTY

(1) No person shall park a vehicle upon public property other than a public highway, including any park, playground, public reserve or school grounds, except as authorized by this Bylaw or permitted by signs erected by the Council or other public authority having jurisdiction.

(2) No person shall drive any vehicle on or across any public property other than a public highway, including any park, playground, public reserve or school ground, except as authorized by this Bylaw or indicated by signs erected by the Council or other public authority having jurisdiction.

(3) This section shall not apply to maintenance vehicles of the Town, in the case of municipal land or the Board of Education, in the case of school grounds.

33. OVERSIZED VEHICLE PARKING

(1) No person shall park a vehicle with:

(i) an actual weight or gross registered weight over 2,725 kilograms; or

(ii) an overall length or more than six (6) meters on any street for more than two (2) hours.

(2) This section shall apply to Town vehicles.

34. DANGEROUS GOODS

(1) No person shall park a vehicle transporting or designed for transporting dangerous goods in bulk within 150 meters of any residence, educational institution or place of public assembly.

(2) Notwithstanding subsection (1), a vehicle carrying or transporting dangerous goods may be parked within 150 meters of any residence, educational institution or place of public assembly for such period of time only as is necessary to unload the contents.

35. DISABLED ZONE

No person shall park or stop a vehicle on any on street parking stall or zone marked by signs as reserved for the disabled unless the vehicle displays a valid disabled licence plate sticker or a disabled placard in the front windshield issued by the Highway Traffic Board or a temporary disabled placard in the front windshield issued by the Saskatchewan Abilities Council.

36. ENGINE RUNNING

No person shall park a vehicle on any public highway with the engine running unless the vehicle remains in charge and under the control of an operator or is completely locked and with the emergency brake on.

37. TRUCKS LOADING

No person shall park a vehicle, including a semi-trailer or trailer combination, on any street with the vehicle backed up to the curb except;

(a) while actually loading or unloading goods onto or from the vehicle; and

(b) where the vehicle does not obstruct more than three meters (3m) of the street, measured perpendicular to the curb.

38. OPENING DOORS

(1) No person shall open the door of a vehicle unless it is safe to do so and can be done without interfering with the movement of traffic.

(2) No person shall leave any door of a vehicle open on the side adjacent to moving vehicular traffic for a period of time longer than necessary to load or unload passengers.

PART VII: RESTRICTED VEHICLES

39. CURRENT LICENCE

(1) No person shall park a vehicle on any public highway unless it displays valid licence plates, with current and valid validation stickers attached to each licence plate, in the manner prescribed in The Vehicle Administration Act, or a registration permit, displayed in the manner prescribed in Section 29 of The Highway Traffic Act.

(2) No person shall operate a motor vehicle not capable of being licensed on any public highway, park, public reserve, sidewalk or other public property.

40. RESTRICTED VEHICLES

(1) Except where a moving permit has been obtained, no person shall operate on any public highway:

(a) any vehicle having contact with the road surface by motorized tracks, including a crawling crane;

(b) any vehicle or load, or both, exceeding the maximum loads set out in Schedule "M" to this Bylaw;

(c) any vehicle, including the load, which exceeds:

(i) 3.7 meters in width unless that vehicle is preceded by a pilot car;

(ii) 24.4 meters in length unless that vehicle is followed by a pilot car;

(iii) 4.2 meters in height;

(d) any farm equipment between sunset and sunrise or between the hours of 7:00 a.m. to 9:00 a.m. and 4:00 p.m. to 6:00 p.m.;

(e) any road construction equipment during the hours of 7:00 a.m. to 9:00 a.m. or 4:00 p.m. to 6:00 p.m. Monday through Friday inclusive or between sunset and sunrise unless the equipment is preceded and followed by a pilot car.

(2) Pilot cars are to be identified in conformity with the Escort Vehicle Equipment Requirement of the Saskatchewan Department of Highways Weights and Dimensions Manual.

41. EXCEPTION FOR PUBLIC WORKS

This part shall not apply to any vehicle owned or operated by the Town or any other public utility while that vehicle is:

(a) actually engaged in maintenance or construction of public works; or

(b) travelling to any site for the purpose of maintenance or construction of a public work.

PART VIII: CYCLISTS**42. BICYCLE LICENCE**

(1) Every owner of a bicycle shall obtain a Town licence for that bicycle, which bicycle must have a serial number stamped on the frame, from the Administrator upon payment of licence fee as set by resolution of Council and completion of a bicycle licence applications.

(2) Bicycle licences issued after December 31, 1989, shall be valid for the lifetime of the bicycle or until ownership of the bicycle is transferred.

(3) Where ownership of a licensed bicycle is transferred, the bicycle licence may be continued upon payment of a bicycle licence transfer fee as set by resolution of Council and completion of a bicycle licence transfer application.

(4) No person may operate or park a bicycle on public property unless that bicycle bears a valid Town licence issued to that bicycle.

(5) Where a bicycle licence is lost or defaced, the owner of the bicycle may obtain a new bicycle licence upon payment of a duplicate bicycle licence fee as set by resolution of Council and completion of a duplicate bicycle licence application.

43. RULES OF ROAD PREVAIL

All cyclists shall abide by the rules of the road.

44. RESTRICTION

No person shall operate a bicycle:

(a) on any sidewalk or boulevard, except a bicycle on a bicycle pathway provided and marked by signs;

(b) while carrying a passenger except upon:

(i) a tandem bicycle; or

(ii) a bicycle equipped with a passenger carrier mounted behind the operator;

and the passenger is seated in the proper seat provided;

(c) in a reckless or negligent manner;

(d) while riding abreast of another cyclist except for the purpose of passing on the left side;

(e) carrying a load:

(i) weighing more than twenty kilograms (20kg);

(ii) of a width greater than that of the cycle;

(iii) which obstructs the clear vision of the cyclist in any direction when seated;

(f) without having at least one hand on the handle bars;

(g) between sunset and sunrise unless the bicycle is equipped with a reflector which is visible to an approaching motorist from the rear and a lighted headlamp which is similarly visible from the front.

45. PARKING

No person shall leave a bicycle in a reclining position on any public highway, sidewalk or public place.

46. IMPOUNDMENT

(1) The Administrator or any police officer or special constable may impound a bicycle;

(a) where the bicycle does not bear a valid Town licence issued to that bicycle;

(b) for any contravention of this Bylaw.

(2) The owner of an unlicensed bicycle which has been impounded may obtain the release of the bicycle by obtaining the licence for the bicycle.

(3) Any bicycle impounded and unclaimed for ninety (90) days or more shall be dealt with as lost or unclaimed personal property.

47. DISABLED PARKING ZONES

The Council is hereby authorized to establish disabled parking zones for the exclusive use of motor vehicles bearing current disabled licence plate stickers or placards and to erect signs to mark such zones.

PART X: ENFORCEMENT

48.

EMERGENCY TRAFFIC

(1) A police officer is hereby authorized to direct traffic in conformity with this Bylaw and The Highway Traffic Act.

(2) Notwithstanding any other provisions of this Bylaw, a police officer is hereby authorized to direct traffic in any manner he deems necessary to expedite traffic, safeguard pedestrians, prevent accidents or meet any unforeseen conditions, whether or not in conformity with this Bylaw or The Highway Traffic Act in the event of a fire, traffic accident or other emergency.

(3) No person shall fail to comply with a direction or signal of a police officer given under authority of this section.

49.

PLACING TICKETS

(1) No person, other than a police officer or special constable authorized by the Council with the enforcement of this Bylaw, shall place a parking ticket on any vehicle.

(2) No person other than the owner or operator of the vehicle, shall remove a parking ticket from a vehicle.

50.

PENALTY

(1) Subject to subsection (2) and (3), any person who contravenes any provision of this Bylaw is guilty of an offence punishable on summary conviction by a fine in an amount not exceeding:

(a) two thousand (\$2,000.00) dollars in the case of an individual;

(b) five thousand (\$5,000.00) dollars in the case of a corporation;

or, in default of payment by and individual, by imprisonment for a term of not more than ninety (90) days.

(2) When a police officer or special constable authorized by Council to enforce this Bylaw has reason to believe that a person or vehicle has contravened any provisions of this Bylaw specified in Schedule "O" to this Bylaw, that police officer or special constable may issue a Notice of Violation to the person or place the Notice of Violation on the vehicle, which Notice of Violation shall indicate that the Town will accept voluntary payment in an amount as prescribed in the Schedule at the Office of the Administrator at the Administration Building, Balgonie, Saskatchewan.

(3) Where the Administrator receives voluntary payment of the prescribed amount, the person receiving the Notice of Violation and the owner of the vehicle shall not be liable to prosecution for the alleged contravention.

(4) Where the Administrator receives payment within ten days after issuance of the Notice of Violation, the prescribed amount may be reduced by fifteen (\$15.00) dollars.

(5) Nothing in this section shall be construed to prevent any person from exercising his right to defend a charge of contravention of this Bylaw.

(6) When a police officer or special constable issues a Summary Offence Ticket Information for a violation of any provisions of this Bylaw specified in Schedule "O" to this Bylaw, that police officer or special constable may enter upon the ticket an amount as prescribed in the Schedule that the Provincial Court will accept as advance voluntary payment.

51. CANCEL TICKET

The Council may cancel any parking ticket where that parking ticket was issued improperly or in error.

52. IMPOUNDMENT OF VEHICLES

(1) Any police officer or special constable authorized by Council may move or remove or cause to be moved or removed any vehicle that is unlawfully parked, placed, left or kept on any public highway, public parking place, other public place or municipally owned property.

(2) Any vehicle removed pursuant to subsection (1);

(a) shall be impounded and stored at the Town Compound or any other place authorized by Council at the cost of the owner for a period of thirty (30) days after the date of removal of the vehicle unless the costs of removal, impoundment and storage and any outstanding fines are sooner paid;

(b) may be released to the owner on payment of the cost of removal, impoundment and storage and any outstanding fines within thirty (30) days after the date of the removal of the vehicle.

(3) If the vehicle is not redeemed within thirty (30) days, pursuant to clause (2) (b):

(a) the vehicle shall be dealt with as lost or unclaimed personal property;

(b) the Town shall have the right to recover from the owner of the vehicle the costs of removal, impoundment and storage, including the actual cost of advertising, by:

(i) action in a court of competent jurisdiction;

(ii) sale of the vehicle at public auction;

(iii) by private sale of the vehicle where the vehicle cannot be disposed of at a public auction.

53. REMOVAL OF OBSTRUCTION

Where an obstruction, encumbrance or encroachment is created or left on any public highway, boulevard or sidewalk, any police officer or special constable or person authorized by Council may remove or cause the removal of that obstruction, encumbrance or encroachment at the cost of the person who caused the obstruction, encumbrance or encroachment and may destroy or otherwise dispose of the obstruction, encroachment.

TOWN OF BALGONIE

PART XI: SEVERABILITY

54. If any section, subsection, sentence, clause, phrase or other portion of this Bylaw is for any reason held invalid or unconstitutional by any Court of competent jurisdiction, that portion shall be deemed a separate, distinct and independent provision and the holding of the Court shall not affect the validity of the remaining portions of the Bylaw.

PART XII REPEAL OF FORMER BYLAWS

55. Bylaw No 104 and amendments thereto are hereby repealed.

PART XIII: EFFECTIVE DATE

56. This Bylaw shall come into effect on the 26th day of March, A.D. 1990.

READ THE FIRST TIME THIS 26th DAY OF MARCH, A.D. 1990;

READ THE SECOND TIME THIS 26th DAY OF MARCH, A.D. 1990;

READ THE THIRD TIME AND PASSED THIS 26th DAY OF MARCH, A.D. 1990.



MAYOR



ADMINISTRATOR

Certified a true copy of
a Bylaw passed by resolution
of Council on the 26th day
of March A.D. 1990.

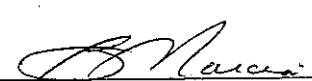

ADMINISTRATOR

TOWN OF BALGONIE

SCHEDULE "A"

(As provided for in Section 7)

HEAVY VEHICLE ROUTE

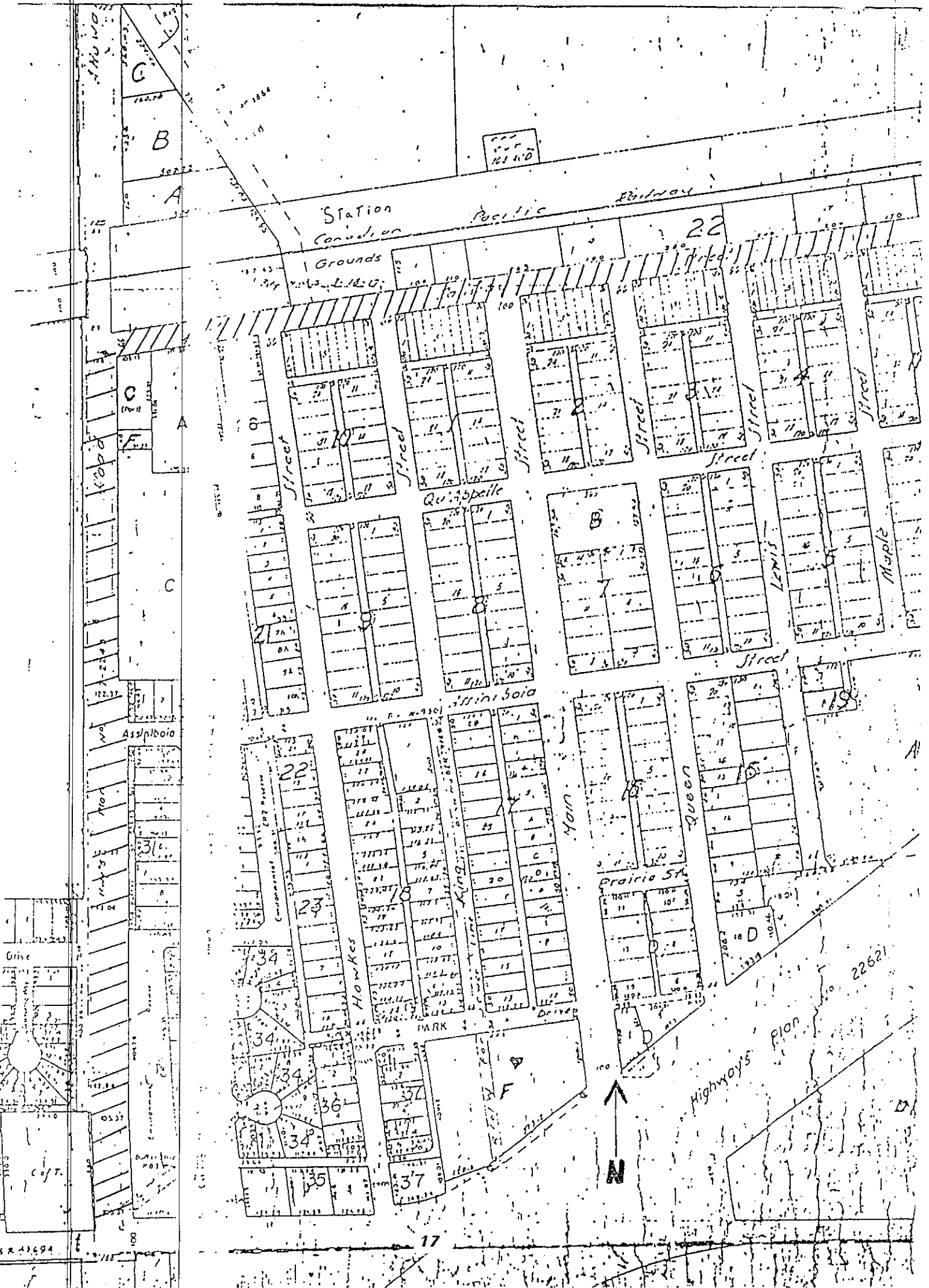

SR 43694

17

TOWN OF BALGONIE

SCHEDULE " B "

(as provided for in Section 9)

PARADE PERMIT

TOWN OF BALGONIE
BOX 310, BALGONIE, SASK. S0G 0E0

Your file _____
Our file _____

PARADE PERMIT

Organization _____

Person in charge _____

Address _____ Telephone No. _____

Date _____ Time _____

Starting Point _____ Dispersal Point _____

Estimated time required to pass a given point _____

Route:

Remarks:

Escort Provided: Yes _____
No _____

ADMINISTRATOR

SCHEDULE "C"
 (as provided for in Section 10)
MOVING PERMIT

Route # _____
 Movers Name: _____
 Address: _____
 Phone: _____

Building Permit # _____
 Owners Name: _____
 Address: _____
 Phone: _____

Description of building, structure or vehicle to be moved:

Length: _____ Width: _____ Loaded Height: _____
 (with or without overhang)
 From: _____ To: _____

Route: _____

1. The applicant must give a minimum of 72 hours notice prior to when he would like to move the above building, structure or vehicle in order to give Sask-Tel, Sask Power, *Town of Balgonie/Public Works* time to co-ordinate the move.
2. The applicant hereby agrees that, if a permit is issued as applied for, the applicant will pay the full amount of any damages resulting or arising from or during the course of the travel for which the permit is sought and will indemnify the approving authorities listed below against any such damages or injury. (Attach copy of Bond of Indemnity or Insurance Policy in the amount of at least one million dollars.)
3. The applicant hereby agrees that if a permit is issued as applied for, that the said applicant will pay any charges levied for the supplying of such men and/or equipment as may be required to assist the applicant to travel the approved route.
4. The applicant hereby agrees that if a permit is issued as applied for that the said applicant agrees to adhere to all existing bylaws that may pertain to the move.
5. The authorized agents, listed below, may suspend or revoke a building move permit where the applicant fails to abide by any condition of the permit or approval or where the applicant supplies false information pertaining to the dimensions of the building, structure or vehicle to be moved.
6. Payment of any charge for cost levied or damages arising from the move is due thirty (30) days after the date of mailing of the bill. Interest of 12%/year is due on any overdue account.
 Deposit received: \$ _____ Date of Application: _____

Name of Applicant: _____
 (Please Print)

Signature of Applicant: _____
 Representing: _____

The above application is hereby approved and authority is hereby granted subject to requirements shown below, to move the building, structure or vehicle described therein over the route described therein on the _____ day of _____, 19__.

Sask. Telecommunications Approval
 (exceeding height of 13'6")

Public Works
 Department Approval

 (Name)

 (Title)

 (Name)

 (Title)

Sask. Power Corporation Approval

Town of Balgonie

 (Name)

 (Title)

 (Name)

 (Title)

SCHEDULE "D"
(as provided for in Section 11)

PERMIT FOR TEMPORARY
STREET/ALLEY ENCROACHMENT

Town of Balgonie - Municipal PUBLIC WORKS - Traffic Division

APPLICANT: _____ PERMIT NO. _____

ADDRESS OF APPLICANT: _____

ENCROACHMENT LOCATION: _____

NATURE OF WORK: _____

THIS PERMIT VALID: _____

BARRICADING

Barriers equipped with flashing lights or reflectors visible to approaching motorists must surround any work or obstruction on the roadway and are to be inspected at least once every twelve (12) hours. Where the barricading is inadequate, the *Town* may in its sole discretion place barriers around the encroachment at the cost of the applicant.

INDEMNIFICATION

The Applicant, in consideration of the granting of this permit, agrees to bear the cost of signing and barricading of the encroachment and to bear the cost of damage to property and to save harmless and keep indemnified the City of Regina from all actions, causes of actions, claims and demands whatsoever, which may be made against the *Town* in consequence of the granting of this permit or of anything done thereunder by the Applicant, his Servants or Agents, and to indemnify and pay to the said *Town* for all damages done to any pavement, sidewalk, curb and gutter or for any damage to any property belonging to the said *Town of Balgonie*

ENCROACHMENT FEE \$ _____

DATED AT BALGONIETHIS _____ DAY OF _____, 19 _____

Name of Applicant (Please Print)

Signature of Applicant:

Representing:

SCHEDULE "D"

(as provided for in Section 11)

TEMPORARY ENCROACHMENT PERMIT

PURPOSE: To allow for short-term construction projects (less than three (3) weeks) or to allow commencement of long term construction projects (over three (3) weeks) pending application to *Town Council* for a temporary road closure. The temporary encroachment permit is available only to the general contractor or owner of the project.

FEE SCHEDULE

Part 1 Permit required for a period of three (3) weeks or less.

Minimum rate for one (1) day	\$ 5.00
Parking lane of street, sidewalk and boulevard -	\$0.50/m ² /week
Alleys and driving lane of street -	\$1.00/m ² /week
Extensions if granted by the <i>Council</i> will be subject to an Administrative fee -	\$ 100.00

Part 2 Permit required for a period beyond (3) weeks (subject to *Town Council* approval).

Minimum rate for one (1) week or less	\$20.00
Parking lane of street, sidewalk and boulevard -	\$0.30/m ² /week
Alleys and driving lane of street -	\$0.60/m ² /week

SCHEDULE "E"

(as provided for in Section 13)

STOP STREETS

The Stop Sign shall indicate to drivers that they shall stop their vehicles completely, before entering the intersection area, and shall not proceed until it is safe to do so.

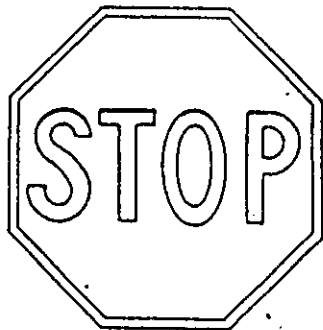

SCHEDULE "F"

(as provided for in Section 14)

YIELD STREETS

The Yield Sign shall indicate to drivers that they must yield the right-of-way, stopping if necessary before entering the intersection area, and shall not proceed until it is safe to do so.

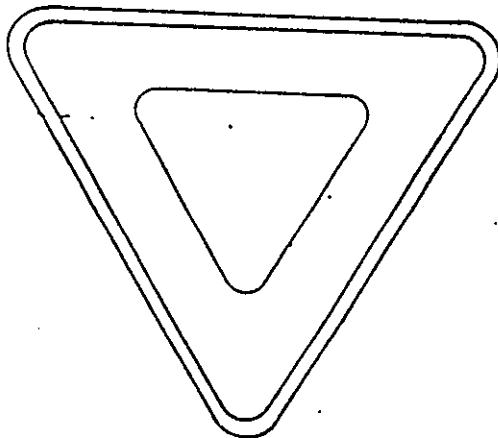

SCHEDULE "G"

(as provided for in Section 15)

PEDESTRIAN CORRIDORS

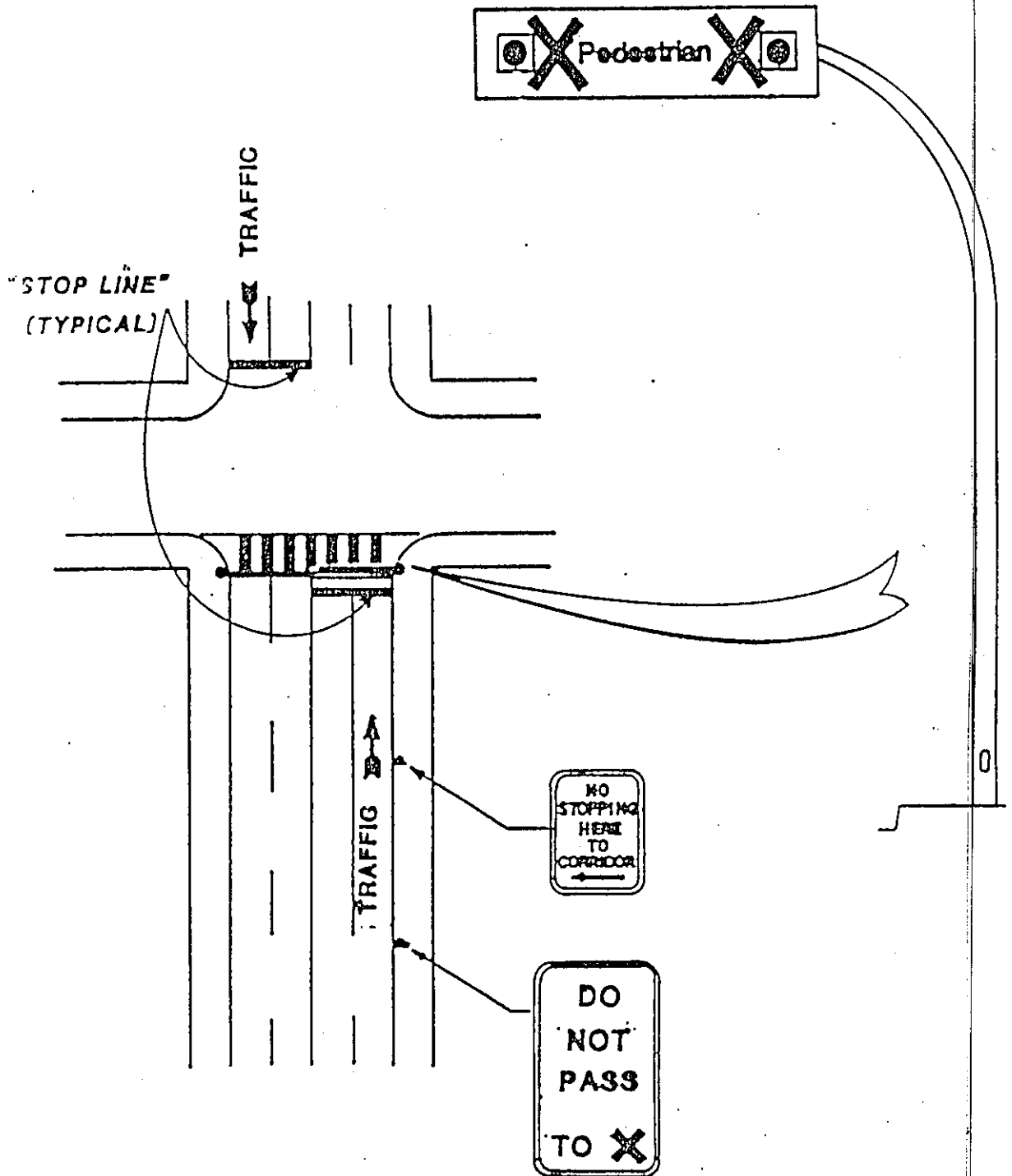

SCHEDULE "H"

(As provided in Section 17)

INTERSECTION SIGHT LINE CONTROL

PURPOSE: To provide a clear line of sight for motorists or pedestrians approaching a street intersection or exiting from driveways, walkways or alleys onto the street.

LEGEND

 (600 mm BACK OF SIDEWALK OR WHERE NO SIDEWALK 2 METRES BACK OF CURB)
 - NO PLANTING, (EXCEPT GRASS),
 FENCE OR OTHER STRUCTURE ALLOWED.

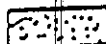
 (SIGHT LINE TRIANGLE)
 - NO PLANTING OR STRUCTURE
 OVER 50 mm IN HEIGHT ALLOWED.

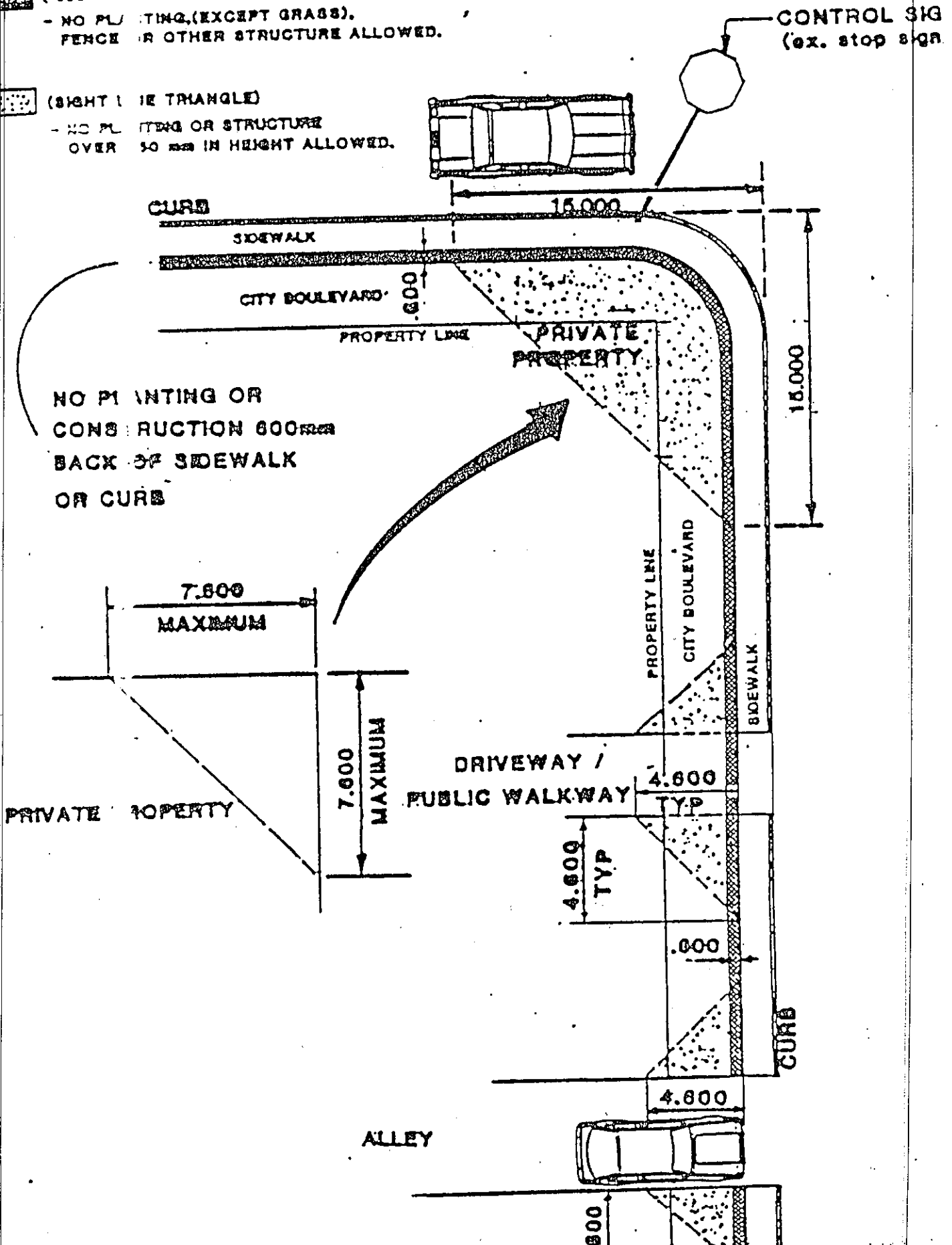

SCHEDULE "H"

MEASUREMENTS

- All dimensions are in metres;
- The sightline for street intersections is measured 15 metres back from the intersection of the curb projections;
- The sightline for alleys and other curb crossings is measured 4.6 metres back of the sidewalk or where there is no sidewalk, the curb;
- No sightline may intrude more than 7.6 metres onto private property.

RESTRICTIONS

- No trees, shrubs, fences or other structures are allowed within 2 metres of the curb or where there is a sidewalk, within 600 mm. back of the sidewalk;
- Trees, shrubs, fences or other structures within the sight line triangle may not exceed 750 mm. in height.
- No walls are permitted on the boulevard, including brick, concrete or other permanent construction. Fences of wood or chain link construction may extend onto the boulevard up to the curb, provided that it complies with this Schedule. Fences placed on the boulevard are, however, subject to removal without notice or compensation from the City to accommodate the construction, maintenance or repair of public works or where the fence falls into disrepair, including aesthetic complaints.

EXEMPTIONS

- This schedule does not apply to traffic control devices or light standards erected by the *Town* or a provincial public utility;
- This schedule does not apply to buildings erected in compliance with the Building and Zoning Bylaws of the *Town* and for which a Building and Development Permit was obtained.

TOWN OF BALGONIE

SCHEDULE " I "

(As provided for in Section 18)

SPEED LIMIT

THIRTY KILOMETERS PER HOUR (1)

Between the hours of 8:00 o'clock in the forenoon and 10:00 o'clock in the afternoon of every day when school is held, on any street adjoining a school ground and marked by appropriate signs erected by the Town.

On any street adjoining any playground so zoned by appropriate signs erected by the Town, between the hours of 8:00 o'clock in the forenoon and 10:00 in the afternoon.

FORTY KILOMETERS PER HOUR (2)

On all other streets other than those mentioned in subsection (1)

SCHEDULE "J"

(as provided for in Section 23 (1))

U-TURNS

Schedule will now show permitted and prohibited U-TURN symbols

U-TURN PROHIBITED

23 (1) (b)

The No-U-Turn sign when used shall indicate that the drivers are prohibited from executing U turns at that location.

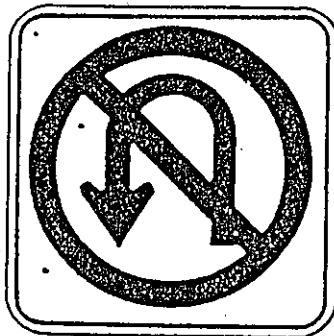

U-TURN PERMITTED

23 (1) (c)

The U-TURN sign when used shall indicate that the drivers are permitted to make U turns at that location.

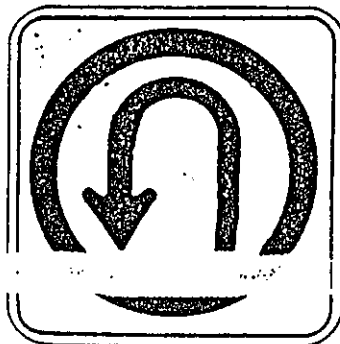

SCHEDULE "K"
(as provided for in Section 30 (a) (b))

NO PARKING

Parking Control sign shall indicate that parking is prohibited at all times on all days, in the direction(s) indicated by the arrow head(s) thereon.

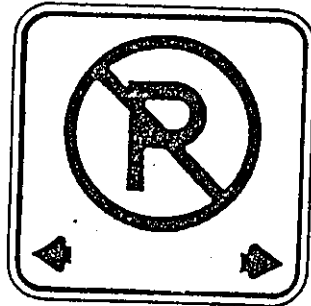

Part-time Parking Control sign shall indicate that parking is prohibited during the time period on the days prescribed in the direction(s) indicated by the arrow head(s), thereon.

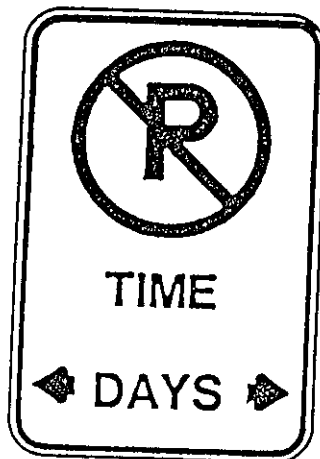

LIMITED PARKING

Parking Limit Control sign shall indicate that parking to a maximum time period is permitted on the days prescribed, in the direction(s) indicated by the arrow head(s) thereon.

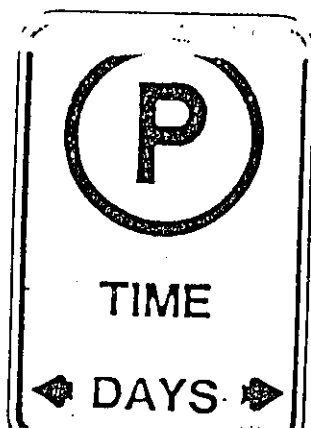

(as provided for in Section 30 (d) (e) (f) (g) (h))

PARKING DISTANCE RESTRICTIONS

- Street intersection - 10 metres — extended curb lines
- Alley intersection - 3 metres — top of flare
- Curb Crossing - 2 metres — top of flare
- Fire Hydrant - 2 metres — centre of hydrant
- Railway track - 5 metres — from Xing arm

drawings showing where dimensions are taken from

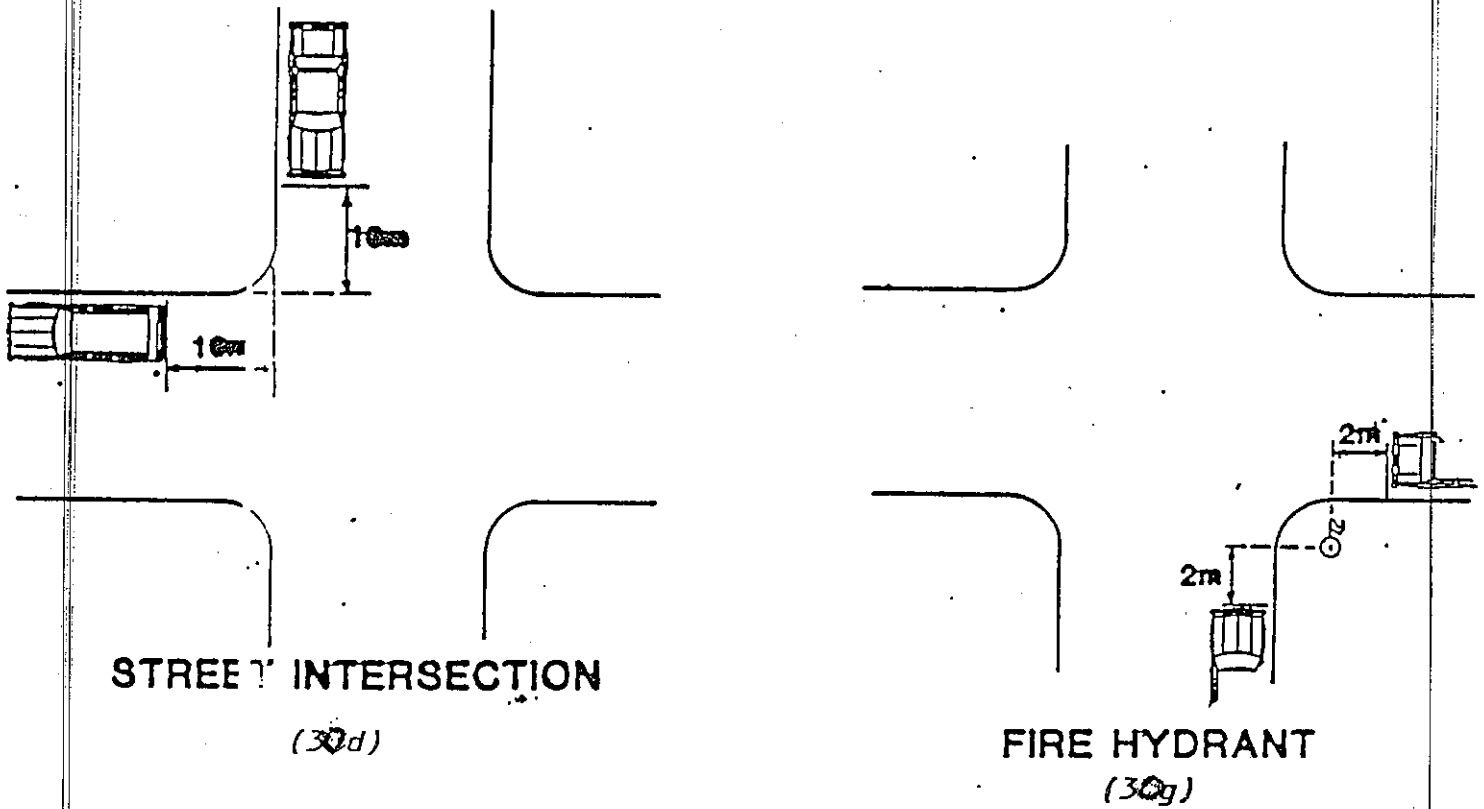

STREET INTERSECTION

(30d)

FIRE HYDRANT

(30g)

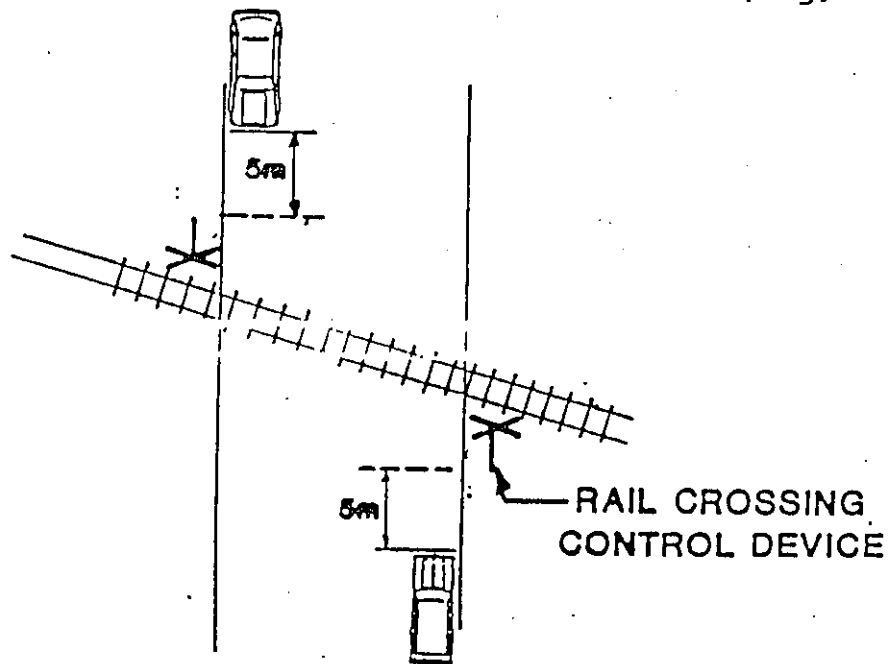

RAILWAY CROSSING

(30h)

SCHEDULE "L"

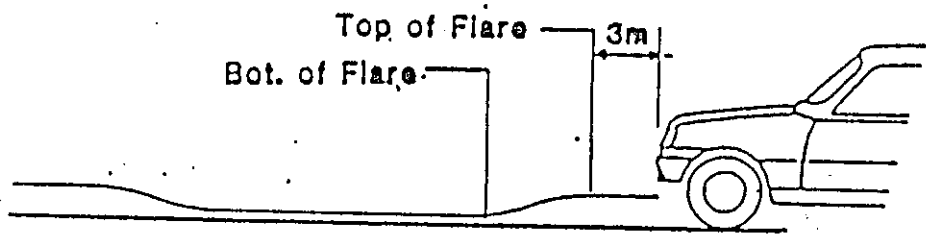

ALLEY INTERSECTION

(30e)

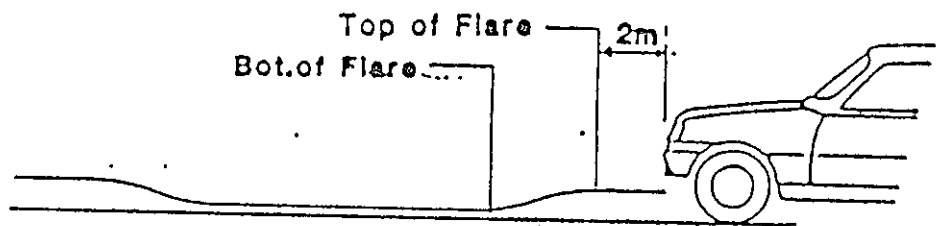

CURB CROSSING (BARRIER CURB)

(30f)

NOTE: Above measurements do not apply when the vehicle is properly parked within a metered parking stall.

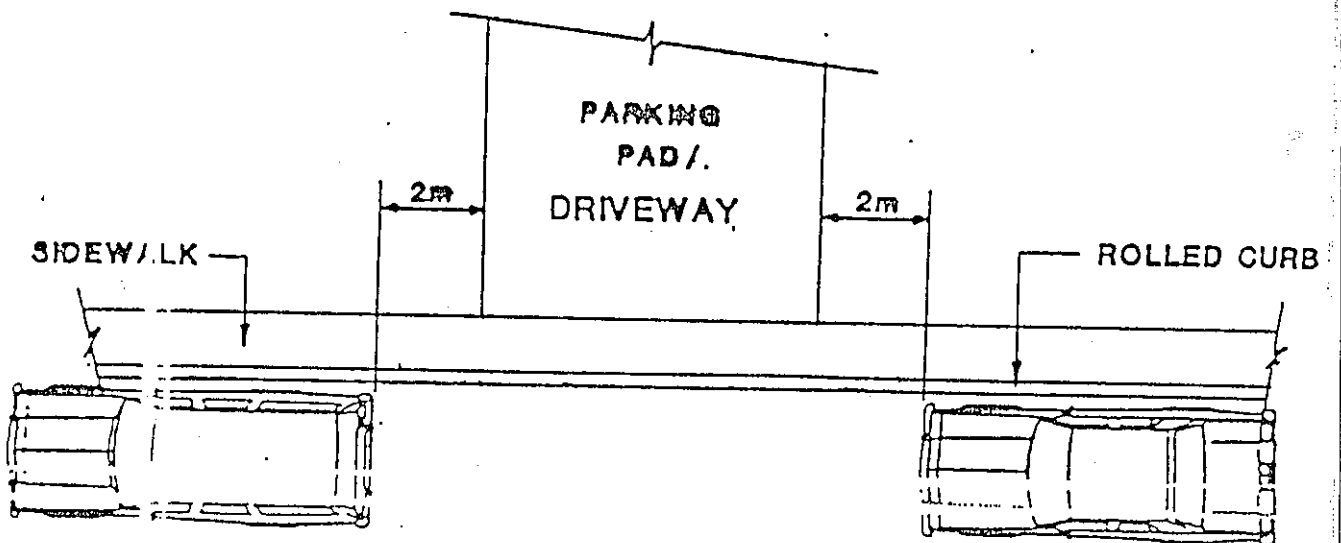

CURB CROSSING (ROLLED CURB)

(30f)

NOTE: A parking pad is defined as any hard surface constructed of concrete, asphalt, gravel, brick or other similar material for the specific purpose of parking vehicles.

SCHEDULE "M"
(as provided for in Section 40(1) (b))

GROSS WEIGHT CHART

<u>Truck Type</u>	<u>Primary Weights</u> <u>March 1 to Nov. 30</u>	<u>Winter Weights</u> <u>Dec. 1 to End of Feb.</u>
Straight Truck: 2 Axles	14,600 kg. 32,000 lbs.	15,500 kg. 34,000 lbs.
Tandem Straight Truck: 3 Axles	21,500 kg. 47,000 lbs.	23,100 kg. 50,800 lbs.
Semi-Trailer Unit: 3 Axles	23,600 kg. 52,000 lbs.	25,500 kg. 56,000 lbs.
Semi-Trailer Unit: 4 Axles	30,400 kg. 67,000 lbs.	33,100 kg. 72,800 lbs.
Semi-Trailer Unit: 4 Axles	30,400 kg. 67,000 lbs.	33,100 kg. 72,800 lbs.
Semi-Trailer Unit: 5 Axles	37,500 kg. 82,000 lbs.	40,700 kg. 89,600 lbs.
Semi-Trailer Unit: 6 Axles	37,500 kg. 82,000 lbs.	40,700 kg. 89,600 lbs.
Straight Truck and Trailer: 4 Axles	32,700 kg. 72,000 lbs.	35,500 kg. 78,000 lbs.
Straight Truck and Trailer: 5 Axles	39,500 kg. 87,000 lbs.	43,100 kg. 94,800 lbs.
Straight Truck and Trailer: 6 Axles	46,300 kg. 102,000 lbs.	50,700 kg. 111,600 lbs.
Semi-Trailer Unit, Full Trailer: 5 Axles - A-Train	41,700 kg. 92,000 lbs.	45,500 kg. 100,000 lbs.
Semi-Trailer Unit Trailer: 7 Axles - A-Train	53,500 kg. 118,000 lbs.	53,500 kg. 118,000 lbs.
Semi-Trailer Unit Trailer: 8 Axles - A-Train	53,500 kg. 118,000 lbs.	53,500 kg. 118,000 lbs.
Semi-Trailer Unit Trailer: 7 Axles - B-Train	53,500 kg. 118,000 lbs.	53,500 kg. 118,000 lbs.

* Subject to minimum axle spacings and adequate tire size.

SCHEDULE "M"

(as provided for in Section 40 (1) (b))

MAXIMUM AXLE AND TIRE LOADS

	Primary Weights March 1 to Nov. 30	Winter Weights Dec. 1 to End of Feb.
Steering Axle	5,500 kg	5,500 kg
Single Axle	9,100 kg	10,010 kg
Tandem Axle Group	16,000 kg	17,600 kg
Semi-Trailer Unit	37,500 kg	40,700 kg
A combination of vehicles	53,500 kg	53,500 kg
A vehicle without rubber tires or any building, object or contrivance	10,000 kg	10,000 kg

Axle Group Loadings

The load on adjacent axles or axle groups is the sum of the individual allowable axle loads, providing the space between the axles meet the minimum spacings provided below:

- 5.0 m (16'4") between two tandem axle groups;
- 3.5 m (11'5") between a tandem axle group and a single axle;
- 3.5 m (11'5") between two single axles;
- 3.35 m (11') between two tandem axles groups on a semi-trailer unit designed for elevation and rear dumping loads or on permanently mounted equipment which allows for rear dumping of loads through a chute connected to a rotating drum.

The provisions of this Section shall not apply to any vehicle owned by or under contract to the *Town of Balgonieor* any other public utility vehicle which such vehicle is:

- (1) actually engaged in maintenance or construction of public facilities;
- (2) travelling to any location for the purpose of carrying out maintenance operations or construction of public facilities.

SCHEDULE "N"

(as provided for in Section 24)

CROSSING CURB

Urban Development Department

Permit for Use of Temporary Curb Crossing

Date: _____

THIS IS TO CERTIFY that _____
of the Town of Balgonie Contractor, Owner, hereby applies for the temporary use
of the boulevard at the following location:

_____ Plan No. _____ Lot _____ Block _____

(Address)

Depth of space allowed _____

Length of time permitted _____ from _____ to _____

I agree to protect the existing curb and sidewalk by planking or other means
and in the event of damage being done to this curb and sidewalk, I will pay
all costs in connection with its repair within 30 days of receipt of Town
invoice.

Name of Applicant: _____

(Please Print)

Signature of Applicant: _____

Representing: _____

Permission is hereby granted, under the provisions of the Balgonie Traffic
Bylaw for the temporary crossing of the above _____ boulevard.

Signed _____

Urban Development Department

TOWN OF BALGONIE

SCHEDULE "O"

(As provided for in Section 50 (2))

PART 1

VOLUNTARY PAYMENTS FOR

NOTICE OF VIOLATION

(Parking Violations)

Balgonie Traffic Bylaw

<u>Bylaw Section</u>	<u>Amount</u>	<u>Bylaw Description</u>
12(2)	\$35.00	Leave vehicle on jack or blocks longer than three (3) hours
16(2)	\$35.00	Leave cord or cable on public highway or sidewalk while attached to vehicle
26	\$25.00	vehicles shall park parallel to curb unless angle parking is indicated by signs or markings.
27	\$25.00	Fail to park at curb in direction of traffic
28(1)(a)	\$25.00	Improper parking at curb - more than 0.3 m. from curb.
28(1)(b)	\$25.00	Improper parking at curb - within 0.6 m. of any vehicle - front or behind
29(a)	\$25.00	Improperly parked in an angle parking stall
29(b)	\$25.00	Improperly parked-front end of vehicle within 0.3 m. of curb
29(c)	\$25.00	Improperly parked-vehicle exceeding 6 m. in overall length
30(a)	\$25.00	Parked where prohibited.
30(b)	\$25.00	Overparking in limited parking area
30(c)	\$25.00	Parked on any alley
30(d)	\$25.00	Parked less than 10 m. from street intersection
30(e)	\$25.00	Parked less than 3 m. from alley intersection
30(f)	\$25.00	Parked less than 2 m. from driveway
30(g)	\$25.00	Parked less than 2 m. from fire hydrant
30(h)	\$25.00	Parked less than 5 m. from railway track
30(i)	\$25.00	Parked in school zone during school days
30(j)	\$25.00	Parked on any sidewalk or curb crossing
30(k)	\$25.00	Parked in a driving lane of any street
30(l)	\$25.00	Parked on any portion of a boulevard
30(m)	\$25.00	Parked on any public highway signed as "Temporary No Parking"
30(n)	\$25.00	Parked on public highway which has been temporarily closed.
30(o)	\$25.00	Parked in a place not accessible to a public highway by a driveway or curb crossing
30(p)	\$25.00	Unlawfully parked on a street longer than 24 hours
31	\$25.00	Park on private property
32(1)	\$25.00	Park on public property
33(1)	\$25.00	Limited parking - oversize vehicles
35	\$25.00	Parked or stopped in a stall or zone marked disabled
36	\$25.00	Engine running without operator present
37	\$25.00	Vehicle backed up to curb obstructing more than 3 m. of roadway
38(1)	\$25.00	Open door of vehicle before safe to do
38(2)	\$25.00	Leave door open longer than necessary to load or unload passengers
39(1)	\$25.00	Vehicle parked on street without current years License Plates
45	\$20.00	Fail to leave bicycle in upright position

TOWN OF BALGONIE

SCHEDULE "O"

(As provided for in Section 50(6))

PART 2

VOLUNTARY PAYMENTS FOR

SUMMARY OFFENCE TICKET

(Moving Violations)

Balgonie Traffic Bylaw

<u>Bylaw Section</u>	<u>Amount</u>	<u>Bylaw Description</u>
7(1)	\$50.00	Drive off heavy vehicle route
7(2)	\$50.00	Fail to proceed to Weight Scale
8(4)	\$40.00	Drive on temporarily closed highway
9(2)	\$40.00	Parade or assembly on highway without permit
9(3)	\$40.00	Cross through or obstruct parade
19(1)	\$40.00	Obstructing traffic on highway
19(2)	\$40.00	Obstructing traffic on sidewalk
20(1)	\$50.00	Vehicle blocking intersection
20(2)	\$50.00	Overtaking vehicle in curb lane of street
21	\$50.00	Failing to yield when pulling out from curb
23(1)(a)	\$50.00	U-Turn at other than uncontrolled intersection
23(1)(b)	\$50.00	U-Turn where prohibited by sign
23(2)	\$50.00	Proceeding before safe after U-Turn
24	\$50.00	Driving over curb
32(2)	\$40.00	Drive vehicle across public property
44(a)	\$20.00	Ride bicycle on sidewalk
44(b)	\$20.00	Carry passenger on bicycle
44(c)	\$20.00	Ride bicycle recklessly
44(d)	\$20.00	Bicycles riding abreast
44(e)	\$20.00	Carry prohibited load on bicycle
44(f)	\$20.00	Ride bicycle without hands
44(g)	\$20.00	Ride bicycle at night without lights
49(1)	\$40.00	Unauthorized person place a ticket on vehicle

SURCHARGE ON FINES AND SENTENCES

RATE OF SURCHARGE

Provincial:

Applies to all Provincial offenses and Municipal Bylaws (except parking violations)

Rates are:

<u>Fine Amount</u>	<u>Surcharge</u>
up to \$100	\$10
\$101 - \$200	\$20
\$200 - \$500	\$30
over \$500	10 per cent
- surcharge on sentence other than fines:	\$20

TOWN OF BALGONIE

SCHEDULE "O"

(As provided for in Section 50 (6))

PART 3

VOLUNTARY PAYMENT NOT ALLOWED

(Court Appearance Required)

Balgonie Traffic Bylaw

<u>Bylaw Section</u>	<u>Amount</u>	<u>Bylaw Description</u>
10(2)	Court Appearance	Building move without permit
15(3)	Court Appearance	Passing vehicle at pedestrian corridor
22(a)	Court Appearance	Splashing pedestrian
22(b)	Court Appearance	Project dirt at person by spinning tires
25	Court Appearance	Driving across fire equipment
39(2)	Court Appearance	Driving unlicensed vehicle
40(1)(a)	Court Appearance	Driving tracked vehicle without permit
40(1)(b)	Court Appearance	Driving over-weight vehicle without permit
40(1)(c)	Court Appearance	Driving over-sized vehicle without permit
40(1)(d)	Court Appearance	Driving farm equipment during prohibited times
40(1)(e)	Court Appearance	Driving road construction equipment during prohibited time
48(3)	Court Appearance	Fail to obey direction of police officer